

# 直接把管道固定在油缸上

管支架 - 衬垫 - 卡扣 - 螺纹喉箍

## Direct tube fastening on a cylinder

Tube support - Adaptor - Clip - Worm thread clamps

### 整套装置包括下列部件:

管支架、衬垫、卡扣和螺纹喉箍。使用单个部件或进行组合可以实现许多不同的装配形式。

例如:

- 在油缸上装配钢管或软管
- 适配不同的钢管或软管直径
- 提供不同的钢管和油缸间距
- 适用不同管子直径的几种管支架可以组合应用

### The complete system consists of the following individual components:

Tube support, adaptor, clip and worm thread clamps. Practical solutions for many different assembly situations can be found by either using an individual component or by combining all the components.

For example:

- Assembly of tubes or hoses on hydraulic cylinder
- different tube or hose diameters
- different distances between tubes and cylinder
- the assembly of several tube supports for different tube diameters

安装:  
一扣即就的装置!

Assembly:  
The "Clip+Ready"-System!

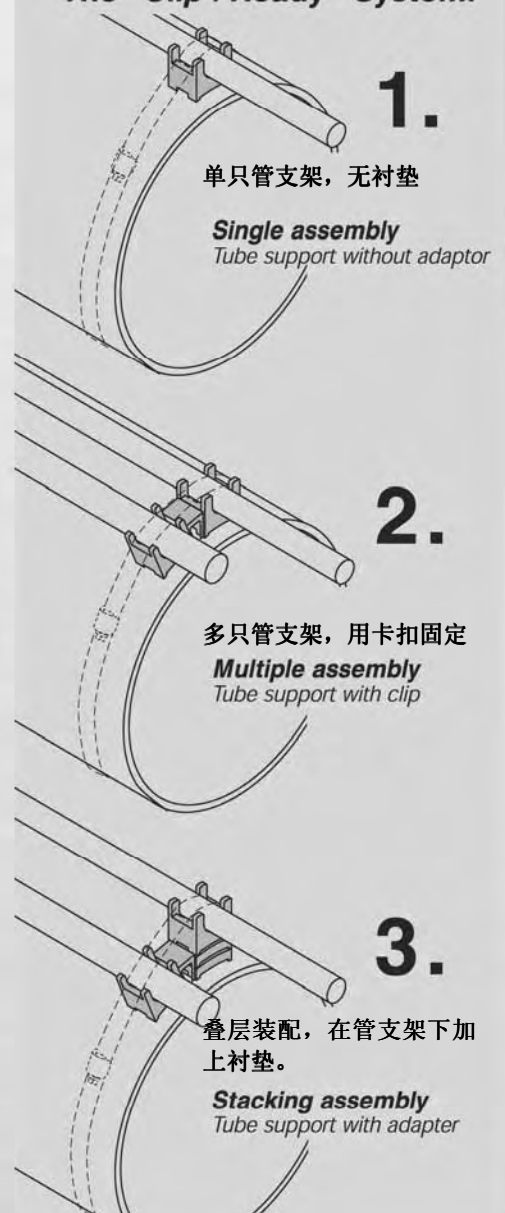



	图 / Figure ①	图 / Figure ②	图 / Figure ③
液压油缸的管道装配形式	单只管支架, 无衬垫	多只管支架, 用卡扣固定, 无衬垫	多只管支架, 用卡扣固定, 采用一或两层衬垫。
Assembly hydr. cylinder	Single-part assembly Tube support without adaptor	Assembly several tube supports with clip without adaptor	Assembly several tube supports with clip and 1 or 2 adaptors
油缸直径 <i>Cylindre ∅</i>	min. ∅ 90 mm	min. ∅ 100 mm	min. ∅ 220 mm

管支架

订购编号: RLP  
材料: 聚丙烯  
通过 RLP 管支架, 用螺纹喉箍可把钢管或软管装配到液压油缸上。  
见图 1。

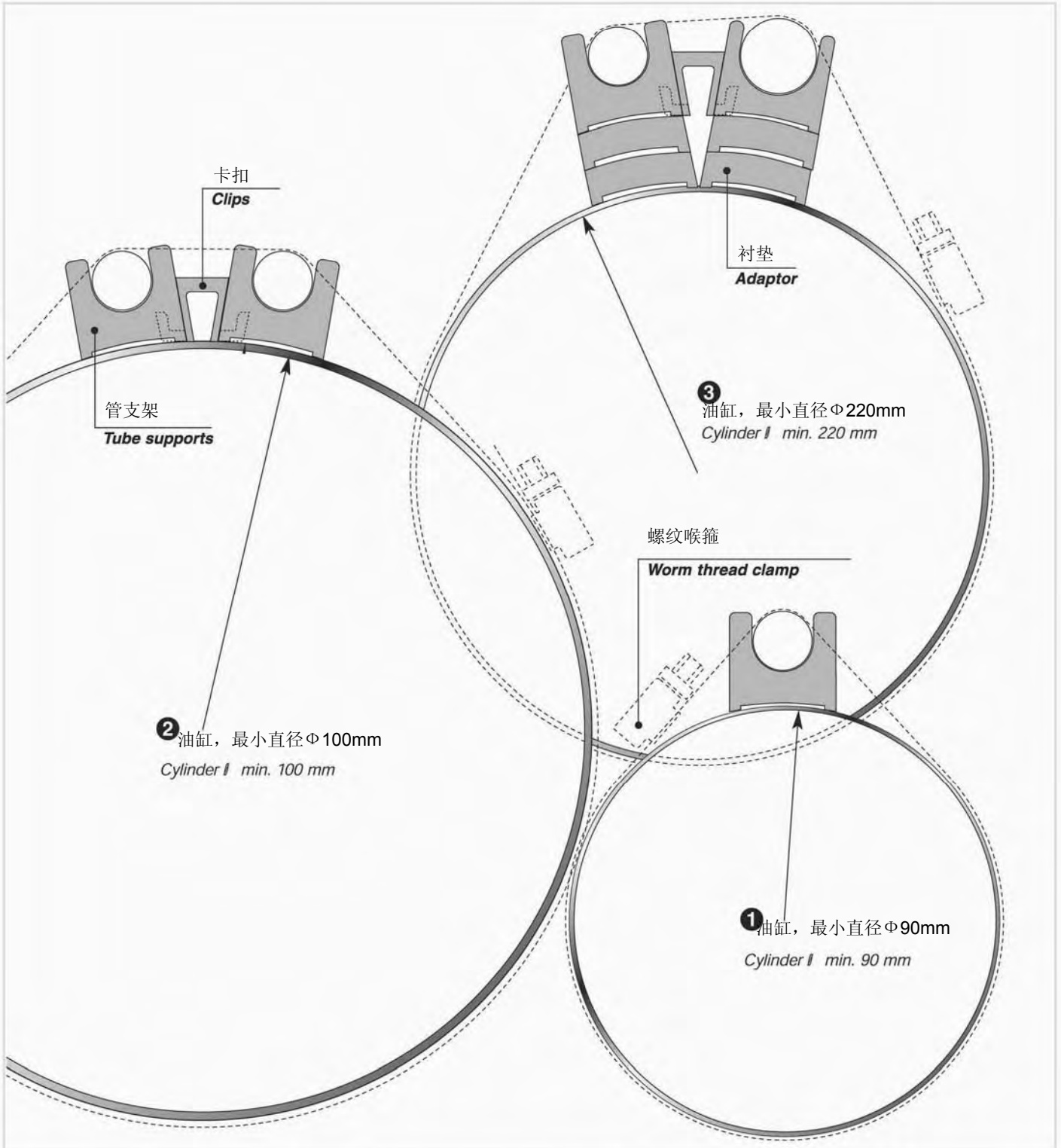
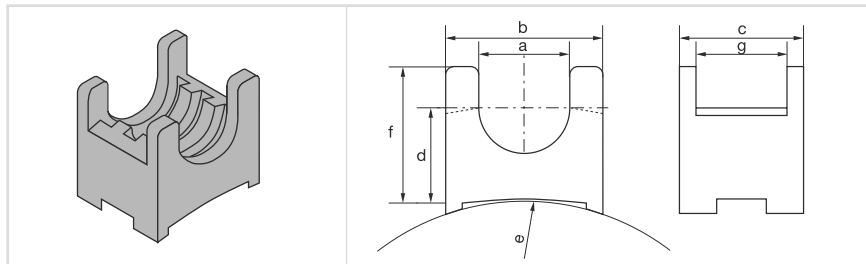

TUBE SUPPORT

Order code: RLP  
Material: Polypropylene  
With the RLP tube support, tubes or hoses can be fitted on hydraulic cylinders by using a worm thread clamp.  
See figure 1

管径 Tube Ø mm	订购编号 Order Codes	a	b	c	d	e	f	g
8	RLP-8	8						
10	RLP-10	10						
12	RLP-12	12						
15	RLP-15	15						
16	RLP-16	16	38	30	21	R 110	32	22
18	RLP-18	18						
20	RLP-20	20						
22	RLP-22	22						
25	RLP-25	25						

衬垫

订购编号: ADP  
材料: 聚丙烯  
ADP 衬垫用于垫在管支架下面, 以增加管子 and 油缸的间距。  
见图 3。

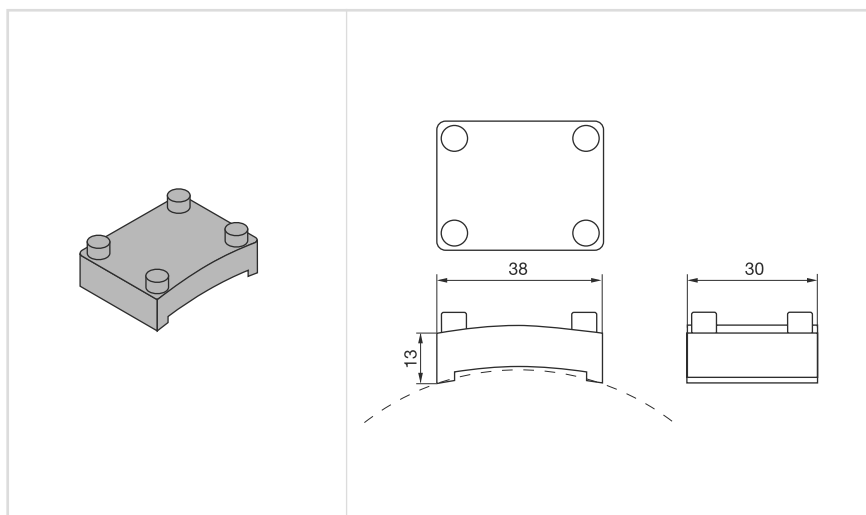

ADAPTOR

Order code: ADP  
Material: Polypropylene  
The ADP adaptor is clipped beneath the tube support in order to get a bigger distance between the tube and the cylinder.  
See figure 3

卡扣

订购编号: KLP  
材料: 聚丙烯  
KLP 卡扣用来把管支架卡接在一起。  
见图 2 和图 3。

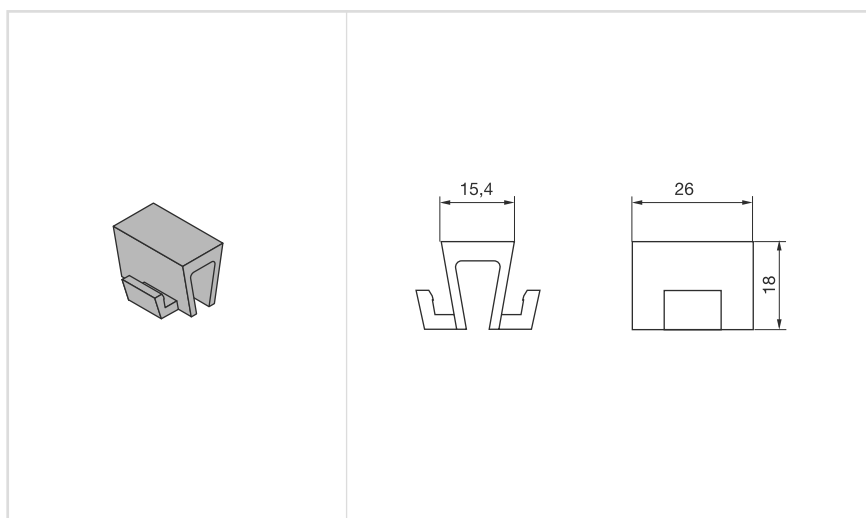

CLIPS

Order code: KLP  
Material: Polypropylene  
KLP clips allow the assembly of tube supports. The tube supports are clipped together with the clip.  
See figures 2 and 3

**螺纹喉箍**

订购编号: SGS

\*在编号后加:

W1: 镀锌钢

W5: 不锈钢 1.4401

\*\*单架单管情形下的尺寸。

在油缸上装配多条管道或/和采用衬垫时, 要使用合适尺寸的喉箍。

**WORM THREAD CLAMPS**

**Order Code:** SGS

\*please add. to order code:

W1: Steel ZN

W5: Stainless steel 1.4401

\*\*Dimensions to use 1 pipe on 1 support!

**Use clamps of the correct size when assembling more than one tube on the cylinder or/and when using the adaptor!**

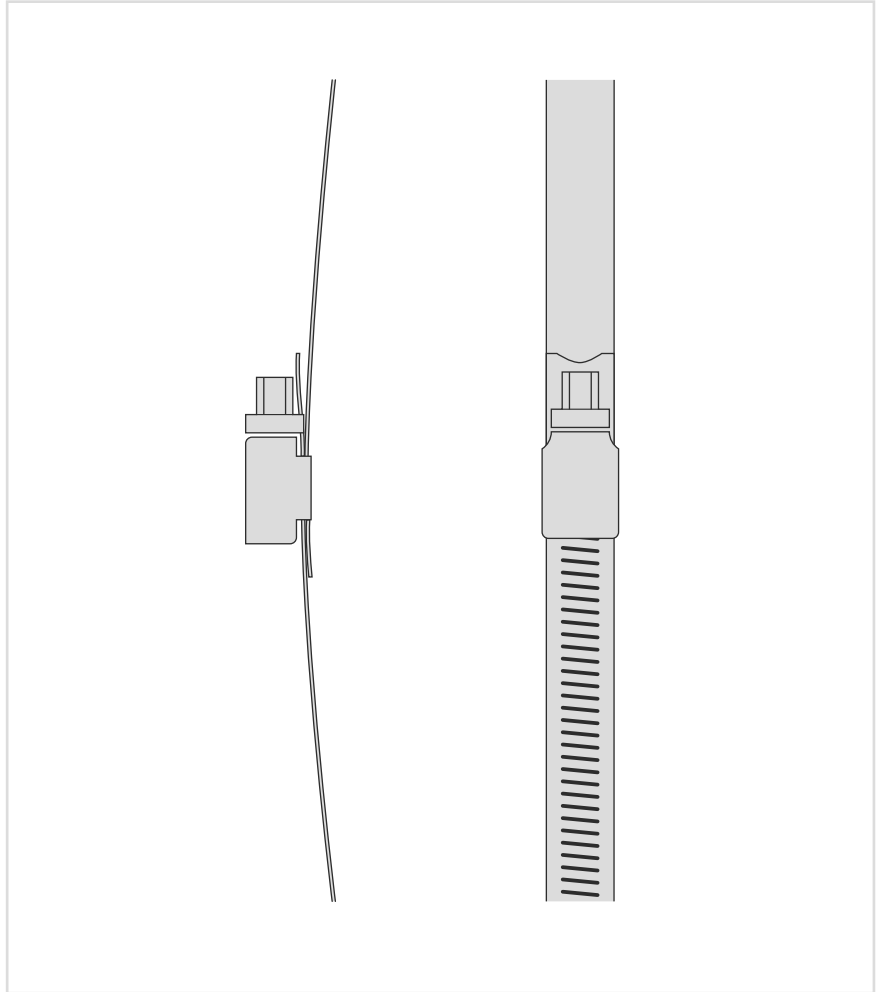

**螺纹喉箍 DIN 3017 / Worm thread clamps DIN 3017**

箍条宽度 Strip width	订购编号 Order Codes	适合油缸直径 (Φ) ** Fits cylinders**
12	SGS-100-120/W*	90 – 110
12	SGS-110-130/W*	100 – 120
12	SGS-120-140/W*	110 – 130
12	SGS-130-150/W*	120 – 140
12	SGS-140-160/W*	130 – 150
12	SGS-150-170/W*	140 – 160
12	SGS-160-180/W*	150 – 170
12	SGS-170-190/W*	160 – 180
12	SGS-180-200/W*	170 – 190
12	SGS-190-210/W*	180 – 200
12	SGS-200-220/W*	190 – 210
12	SGS-210-230/W*	200 – 220
12	SGS-220-240/W*	210 – 230
12	SGS-230-250/W*	220 – 240
12	SGS-240-260/W*	230 – 250
12	SGS-250-270/W*	240 – 260
12	SGS-260-280/W*	250 – 270